

UL Standard Fuses(VRA 150V AC/DC)



A type contact



B type contact

Ordering Information:

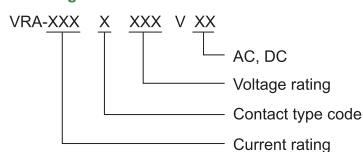

Notes: Contact type code: A or B

Description:

VRA semiconductor protection fuses were designed for the specific protection of diodes and other semiconductor devices rated 150V AC/DC.

The VRA product line's compact design is perfect for those applications that have limitations on available space

VRA rated at 150V is a kind of fast acting fuse designed according to UL standard.

Features:

- Designed according to UL248
- Complying with CE and RoHS
- Suitable for short-circuit
- Operating class : aR

Ratings :

Voltage Rating : 150V AC/DC
Current Rating : 70A-6000A
Interrupt Rating : 100kA AC
20kA DC

Electrical Characteristics:

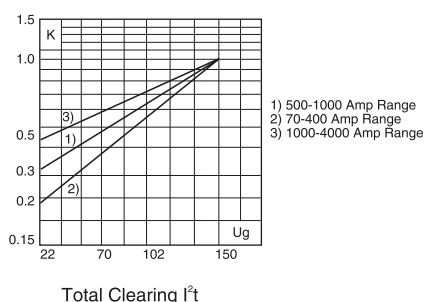

Total Clearing I^2t

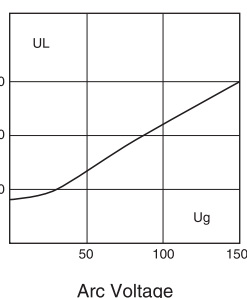

Arc Voltage

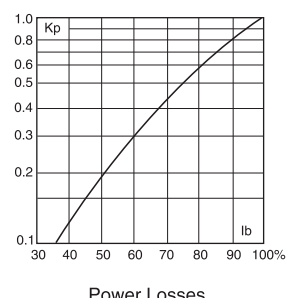

Power Losses

Mechanical Dimensions:

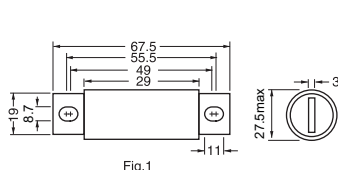

Fig.1

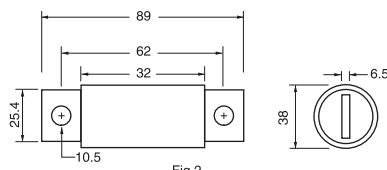

Fig.2

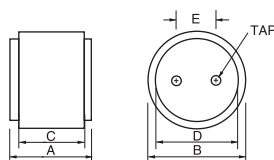

Fig.3

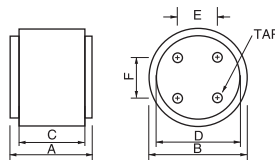

Fig.4

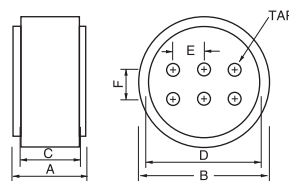

Fig.5

Catalog Numbers	Ref. Fig.	Current Rating(A)	Mechanical Dimensions(mm)						TAP
			A	B	C	D	E	F	
VRA	1	70-400	shown in fig.1						—
VRA	2	500-1000	shown in fig.2						—
VRA	3	750-2000	48	51	41	45	25	—	—
VRA	3	2500-3000	48	76	41	64	38	—	—
VRA	4	3500-4000	48	89	41	76	27	27	—
VRA	5	4500-6000	61	146	48	127	38	38	—

● **Electrical Specifications:**

Catalog Numbers	Current Rating (A)	Pre-arc I ² t(A ² s)	Clearing I ² t(A ² s)	Power Loss (W)	Voltage Rating	Interrupt Rating	Remark
VRA	70	450	3000	6.6	150V AC 150V DC	100kA@150V AC 20kA@150V DC	aR A/B type Contacts
	80	650	5000	7.4			
	100	1150	11000	8.9			
	125	1800	17000	11			
	150	2560	24500	13			
	200	4700	43000	17			
	250	7400	67000	21			
	300	10510	95000	26			
	350	15200	132000	29			
	400	20000	164000	34			
	500	36500	116000	34			aR A type Contacts
	600	45500	125000	46			
	700	74000	216000	48.8			
	800	91000	264000	55.6			
	1000	164000	483000	58.0			
	1200	590000	670000	90.0			
	1500	1020000	1100000	120.0			
	1600	1030000	1100000	125.0			
	1800	1300000	1400000	140.0			
	2000	1620000	1800000	155.0			
	2500	2790000	3000000	180.0			
	3000	4150000	4500000	230.0			
	3500	5250000	6000000	240.0			
	4000	7040000	8000000	250.0			
	5000	9760000	11000000	300.0			
	6000	13000000	16000000	350.0			

● **Electrical Characteristics:**

Average Time-Current Curve

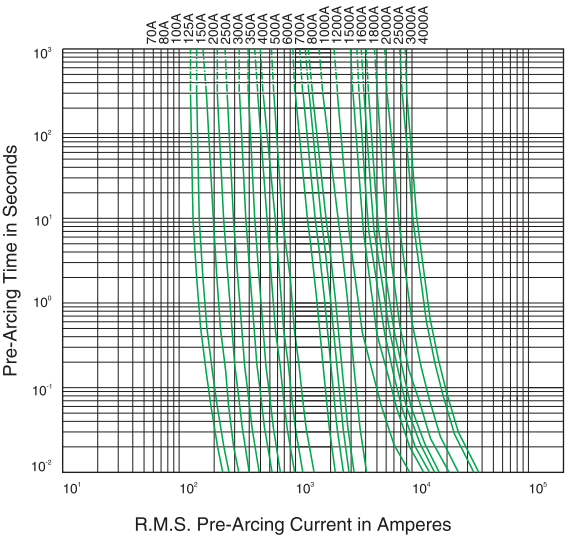

Peak Let - Thru Curve

